

**PLAN VIEW**  
(DRY WELL RING)

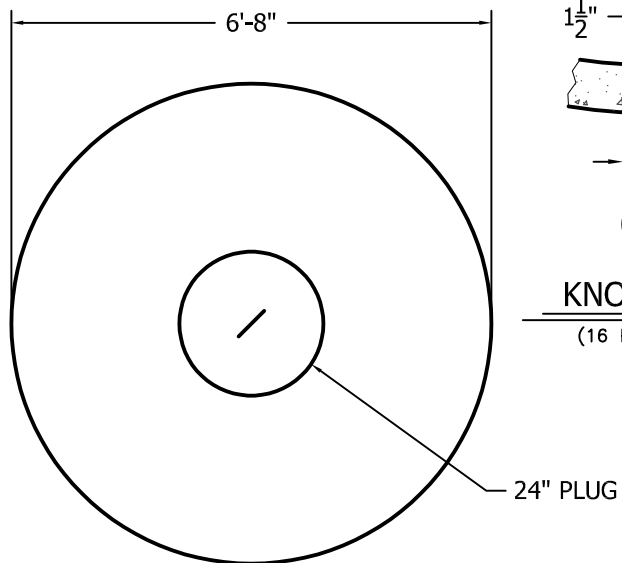

**PLAN VIEW**  
(ROOF SLAB)

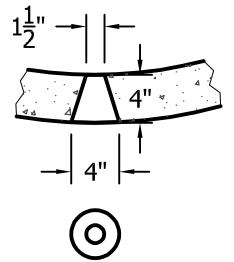

**KNOCKOUTS**  
(16 PER ROW)

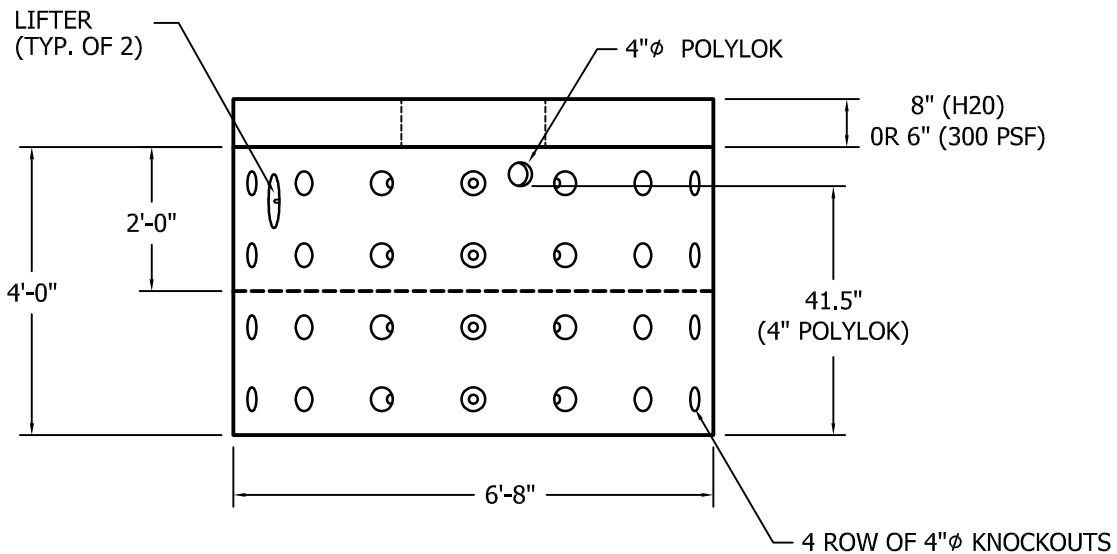

**FRONT VIEW**  
(4 FT. HIGH)

**GENERAL NOTES:**

- 1) CONCRETE TO TEST 4,500 PSI AT 28 DAYS.
- 2) DRYWELL VOLUMES:
 

4 FT.	730 GAL.
2 FT.	308 GAL.

<b>WEIGHT:</b>	
ROOF SLAB 6" (300 PFS)	- 2,584#
8" H20	- 3,467#
DRY WELL 4 FT.	- 3,760#
2 FT.	- 1,880#



7 Ruscitti Road  
New Windsor, New York, 12553  
www.arconcrete.com  
845-562-0640

<b>PRECAST CONCRETE DRYWELL</b> 6' I.D.X 4' OR 2' H., 4" W., 6" OR 8" ROOF SLAB		DATE:	11/18/2021
		REV.:	
		DWN.BY:	AR LLC
CONTRACTOR:	JOB. NO.:	DWG. NO.:	
A&R CONCRETE PRODUCTS	--	DRYWELL	